

CAUTION:

Azimuth range is 112 degrees. 65 degrees west and 47 degrees east. Proper orientation of kingpost on foundation is critical.

NOTES:

1. INCREASE FOUNDATION AS REQUIRED TO REACH MAXIMUM FROST DEPTH.

2. SOIL - "NORMAL SOIL" AS DEFINED BY TIA-E1A-222F WITH ALLOWABLE VERTICAL BEARING CAPACITY OF 4000 PSF.

3. CONCRETE: 4000 PSI @ 28 DAYS. ALL CONCRETE WORK SHALL BE IN ACCORDANCE WITH ACI 318.

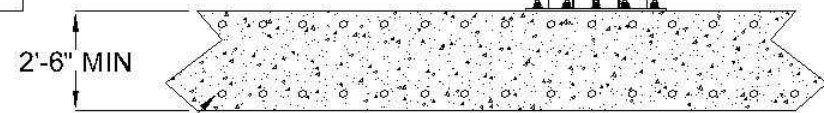

#6 Rebars @ 10" C-C Spacing
w/ 2" Concrete Cover at Top
and 3" Cover at Bottom.
ASTM A 615, Grade 40 or 60.

AMERICAN ANTENNA INC. 219-985-4000 www.americanantenna.com	
DRAWN: TJV	5m Foundation Overview
DATE: 05/29/08	
REV:	DWG. NO. 5-100504